

Model **ME** MAGNETIC LAMP STAND

Regular lamp stand! ME Series!



[Application]

The magnetic lamp stands allow the magnet to be turned on and off quickly, and thus can easily be installed in any place, removed and relocated. These stands are most suitable for lighting work areas on work tables or machine tools.

Small and compact, but the strong magnetic holding power enables this stand to be installed not only on a horizontal surface, but on an inclined surface easily. The flexible tube offers freely selectable lighting angles.

(ME-2CA-R)

- Illuminance tripled and heat generation reduced 50%. Great power saving.
- Problems associated with incandescent lamps having good color rendering*1 have been resolved.

*1 Color rendering ... A level of easiness of reading vernier scales and fine articles.

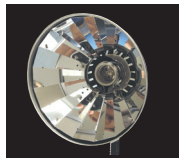

Comparison of illuminance when the special reflective plate is used and not used (LUX)

Bulb	Reflective Plate Used	Reflective Plate Not Used
40W	850	300
60W	1300	420
100W	2100	640

Model	Type	Holding Power	Height	Cord Length	Bulb Capacity	Mass
ME-2CA	Standard type	800N (80kgf)	440 (17.3)	1.6m (62.9)	100 VAC Upper limit 100W, optimum 60W	1.6kg/3.5 lb
ME-2CA-R	Reflective plate type	800N (80kgf)	440 (17.3)		100 VAC Upper limit 100W, optimum 40W	1.6kg/3.5 lb
ME-N2A	Simple type	300N (30kgf)	460 (18.1)	1.6m (62.9)	100 VAC Upper limit 100W, optimum 60W	1.2kg/2.6 lb
ME-L2C	Tall type	1000N (100kgf)	704 (27.7)		100 VAC Upper limit 100W, optimum 60W	2.2kg/4.8 lb
ME-F1C	Fluorescent lamp type	1000N (100kgf)	440 (17.3)			2.0kg/4.4 lb

※When using a stand with a 100W incandescent lamp for long hours, rating-related problems will not arise, but caution must be taken against overheating when handling it. ※Depending on the dimensions of bulb type fluorescent lamps, they may be used on ME-2CA. ※The holding power is based on a test piece of SS400, 10 mm thick, ground surface. ※The power plug is of tracking resistance type.

[Features]

- While the installation position is fixed by the attractive face, the lighting direction can be changed as desired.
- The protective guard protects the bulb from breakage if the stand falls.
- The employment of an oil-resistant power cord allows these stands to be used on various work sites.

Parts available individually

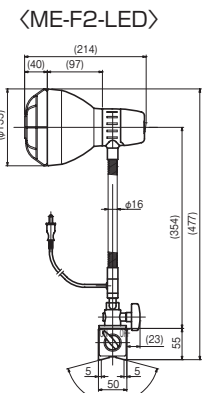
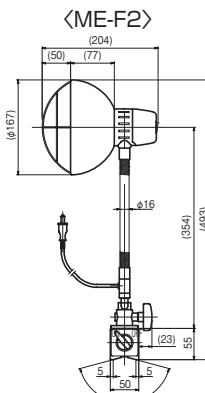
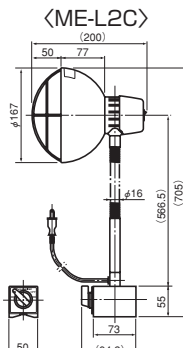
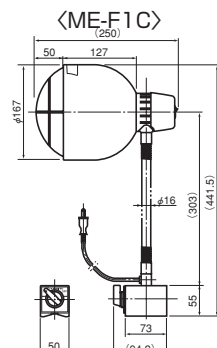
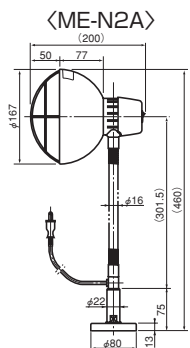
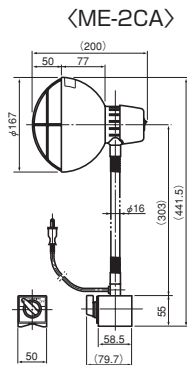
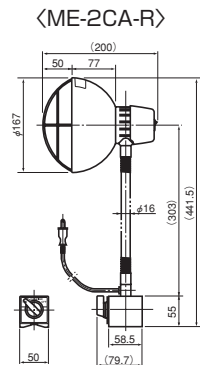
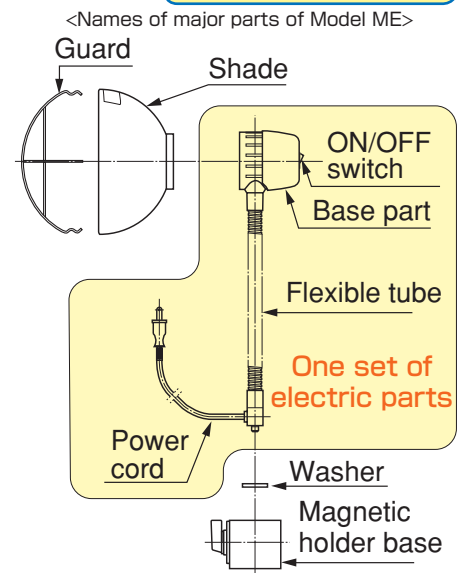

※The bulb is not included. Use a bulb of base E26.



Precautions for use

- A lamp to use must be of the correct rating. The use of a lamp exceeding the rating will cause injury or accident due to heat.

ELECTROMAGNETIC CHUCKS
CHUCK
CONTROLLERS
PERMANENT ELECTROMAGNETIC CHUCKS
MAGNETIC CHUCKS
BLOCKS FOR MC
VACUUM CHUCKS
PROMELTA* SYSTEM
SINE BAR CHUCKS
BLOCKS HOLDERS, MINI CHUCKS
HOLDING TOOLS
MEASURING TOOL HOLDERS
MAGNETIC HOLDERS
MAGNETIC TOOLS